

PRESSURE SENSOR WITH STAINLESS STEEL DIAPHRAGM

Pressure ranges 0...0,35 up to 0...600 bar
Accuracy 0,5% FS



DRUCK & TEMPERATUR

The pressure sensor with a piezoresistive sensor element is characterized by high accuracy, reliability and stability.

Applications

Industry and mechanical engineering
Pneumatics and hydraulics
Oil and gas industry
Chemical industry
Plant engineering and automation technology



Type	3330	3335	3377	3378	Options
Pressure ranges	0...0,35 bar up to 0...600 bar				Vacuum and mano- vacuum meas. ranges
Output signal	4...20 mA 2-wire	0...10 V 3-wire	4...20 mA 2-wire	0...10 V 3-wire	0,5...4,5 V - 3-wire 0...5 V - 3-wire 1...5 V - 3-wire
Power supply	8...30 V DC	12...30 V DC	8...30 V DC	12...30 V DC	
Accuracy acc. to IEC 60770	±0,50 % FS including linearity, hysteresis und repeatability				±0,25 % FS
Thread	G 1/4 A ISO 1179-2		G 1/2 B EN 837		others on request
Electrical connection	Hirschmannstecker DIN 175301-803 A				DIN 175301-803 C Cable connection
Insulation resistance	500V DC				
Long-term stability	max. ±0,3%FS / year				
Load cycle	max. 10 ⁷				
Temperatures	Medium: -10°C...+125°C Ambient: -10°C...+105°C Storage: -40°C...+125°C				
Case material	Stainless steel 316L				
Material wetted parts	Stainless 316L				
Rectangle sealing ring	Viton				
Impact resistance	100g/11ms according to IEC 60067-2-27				
Vibration resistance	10g (@20Hz-200Hz) according to IEC 60068-2-6				20g
Protection class	IP65				
Weight	Welded (up to 200 bar) ≤150 g , Assembled (250 bar up to 600 bar) ≤200 g				

Type 3330, 3335, 3377, 3378

Dimensional drawings types 3330 and 3335

Dimensions in mm

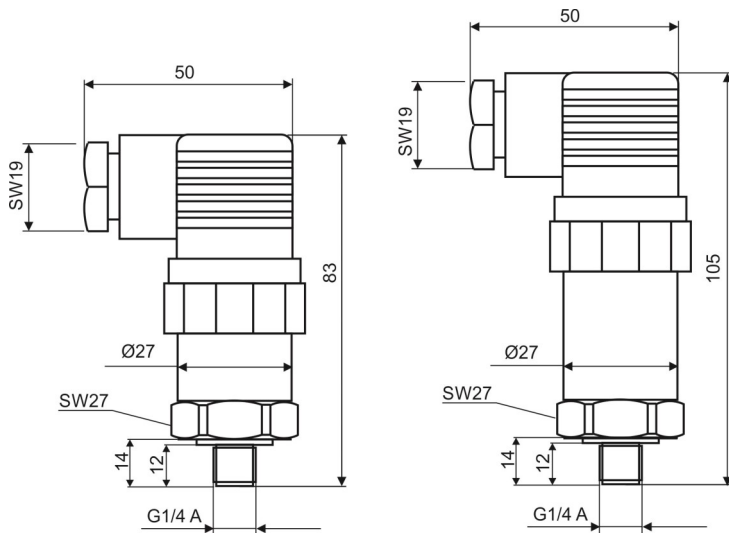

0...0,35 up to 0...200 bar

0...250 up to 0...600 bar

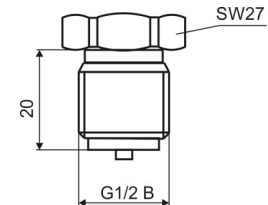

Thread G1/2B
Types 3377 and 3378

Electrical connection
DIN 175301-803-A

Connection diagram

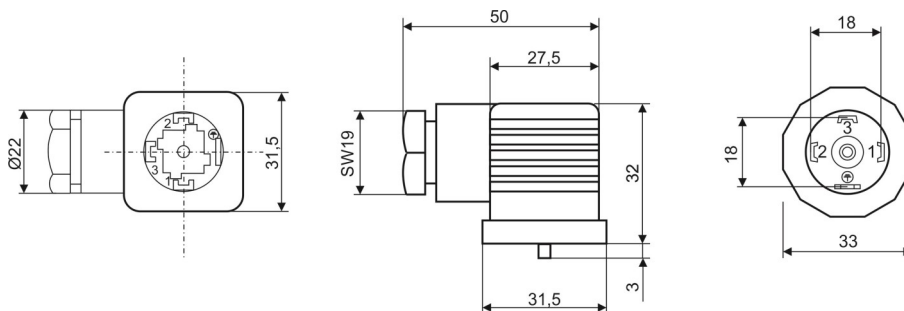

Pin	2-wire	3-wire
1	UB+ (+V)	UB+ (+V)
2	out (0V/+OUT)	UB- (GND)
3	nc Null	out (+OUT)

Pressure ranges and limits (bar)

Range	max. overpressure	min. burst pressure
0...0,35	1	5
0...0,6	1,8	5
0...1	3	5
0...1,6	3	5
0...2,5	5	10
0...4	8	12
0...6	12	20
0...10	20	30
0...16	30	60
0...25	50	75
0...40	80	120
0...60	120	180
0...100	200	300
0...160	300	400
0...200	300	400
0...250	400	500
0...400	600	800
0...500	750	1000
0...600	750	1000

SUKU Druck- und Temperaturmesstechnik GmbH

Garndorfer Hauptstraße 109 • 09244 Lichtenau / Sachsen - GERMANY
Tel.: +49 37208 / 2717 • Fax: +49 37208 / 61713 • contact@suku.de • www.suku.de